

FLOODPLAIN SECTIONS
Chainage 180.000

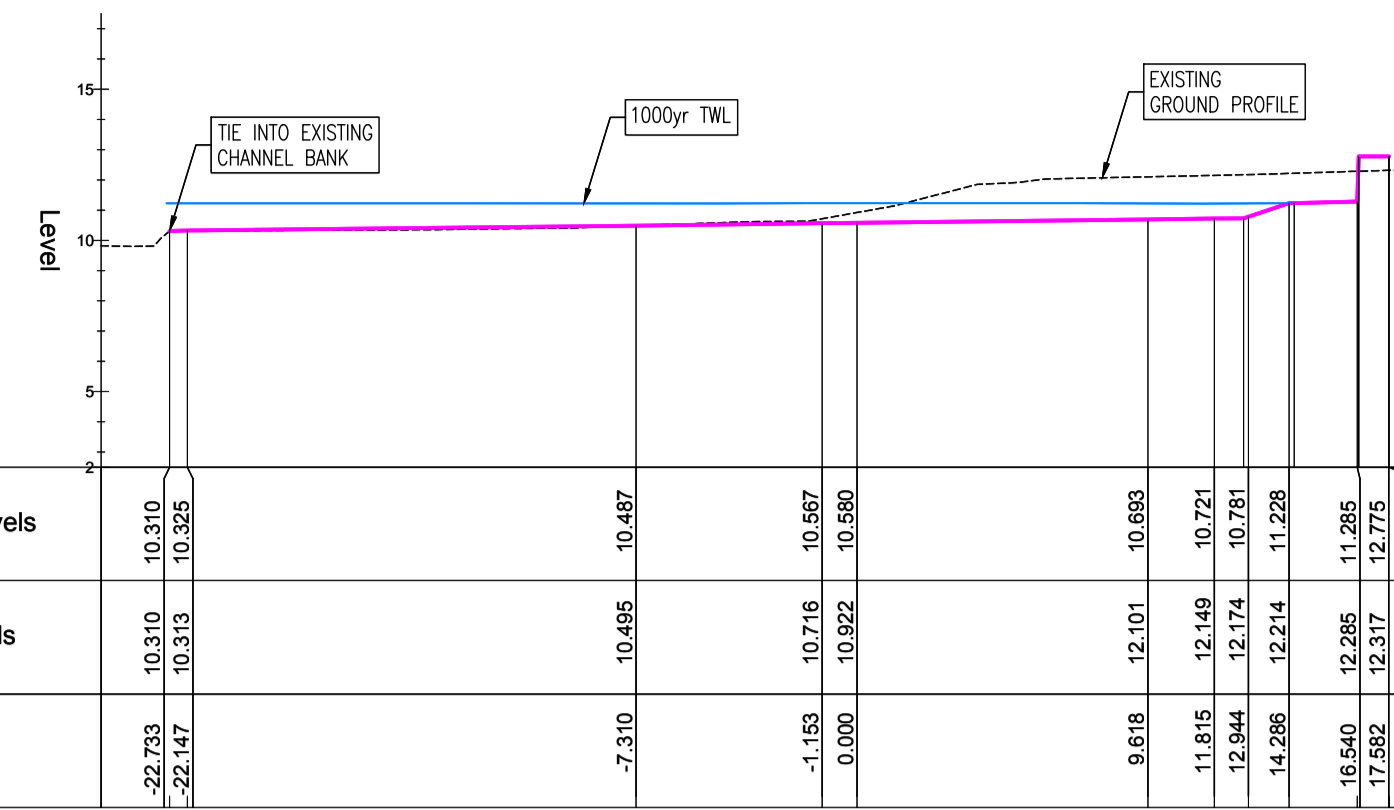

FLOODPLAIN SECTIONS
Chainage 190.000

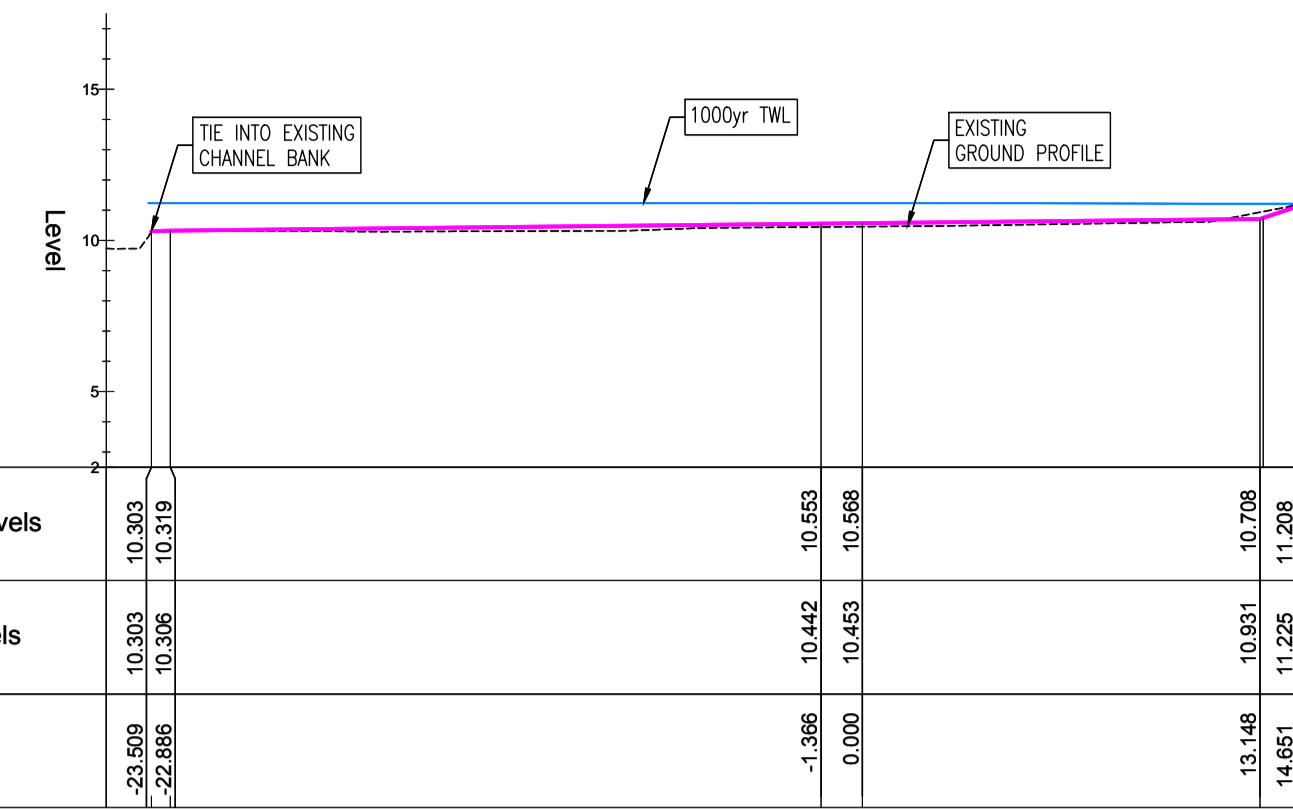

FLOODPLAIN SECTIONS
Chainage 196.000

© COPYRIGHT OF THIS DRAWING IS RESERVED BY DBFL CONSULTING ENGINEERS. NO PART SHALL BE REPRODUCED OR TRANSMITTED WITHOUT THEIR WRITTEN PERMISSION.

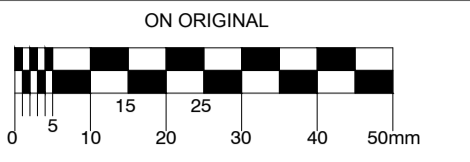

- NOTES:
- GENERAL NOTES:
- ALL DRAWINGS TO BE CHECKED BY CONTRACTOR ON SITE AND ENGINEER INFORMED OF DISCREPANCIES BEFORE WORK COMMENCES.
 - THE CONTRACTOR SHALL SATISFY HIMSELF AS TO THE ACCURACY OF EXISTING DRAINAGE LEVELS AND LOCATION OF EXISTING SERVICES ON SITE PRIOR TO COMMENCEMENT OF WORKS ON SITE.
 - ALL DIMENSIONS AND LEVELS ARE IN METERS AND ARE RELATED TO ORDINANCE DATUM. CO-ORDINATES RELATE TO IRISH NATIONAL GRID.
 - ALL MATERIAL USED IN FLOODPLAIN MODIFICATION TO BE IN ACCORDANCE WITH BS SERIES 600 SPECIFICATIONS.
 - REFER TO DBFL SITE SPECIFIC FLOOD RISK ASSESSMENT.

REV.	DATE	DESCRIPTION	BY	CHKD.
PLANNING				
DESIGNED	NGC	PREPARED	PGC	
DATE	APR 2019	CHECKED	DJR	

DBFL

DUBLIN OFFICE: Ormond House, Upper Ormond Quay, Dublin 7, Ireland. PHONE +353 1 400 4000 FAX +353 1 400 4050

WATERFORD OFFICE: Unit 2, The Chandlery, 1-2 O'Connell Street, Waterford, Ireland. PHONE +353 51 309 500 FAX +353 51 844 913

DBFL Consulting Engineers email: info@dbfle.ie; www.dbfle.ie

PROJECT
**PARKSIDE 4,
PARKSIDE, DUBLIN 13**

DRG. TITLE
**CROSS SECTIONS THROUGH
PROPOSED FLOODPLAIN
WORKS SHEET 2**

CLIENT
**CAIRN HOMES PROPERTIES
LTD.**

SCALE: 1:250 @A1 FILE REF: 190011-3002
DRG. NO. **190011-3004**

